

REPLACEMENT

1. REMOVE ENGINE UNDER COVER SUB-ASSY NO.1
2. REMOVE ENGINE UNDER COVER ASSY REAR
3. DISCONNECT OXYGEN SENSOR(See page 15-2)
4. REMOVE EXHAUST PIPE(See page 15-2)
5. REMOVE PROPELLER SHAFT ASSY FRONT(See page 30-4)
6. REMOVE PROPELLER SHAFT ASSY(See page 30-1 1)
7. DRAIN AUTOMATIC TRANSMISSION FLUID
 - (a) Remove the drain plug, gasket and drain ATF.
 - (b) Install a new gasket and drain plug.

Torque: 28 N·m (285 kgf·cm, 21ft·lbf)

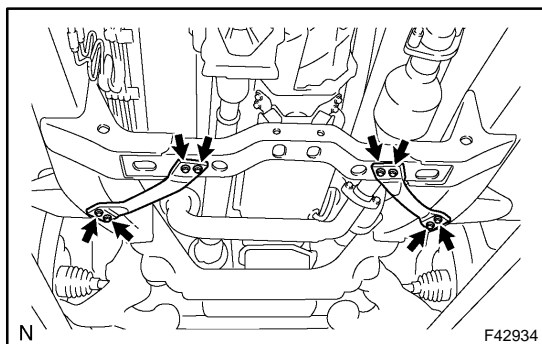

8. REMOVE FRONT SUSPENSION MEMBER BRACKET
 - (a) Remove the 4 bolts and front suspension member bracket.
9. REMOVE FRONT SUSPENSION MEMBER BRACKET LH
 - (a) Remove the 4 bolts and front suspension member bracket LH.

10. REMOVE TRANSMISSION OIL FILLER TUBE SUB-ASSY

- (a) Remove the ATF level gauge.
- (b) Remove the bolt and oil filler tube.
- (c) Remove the O-ring from the oil filler tube.

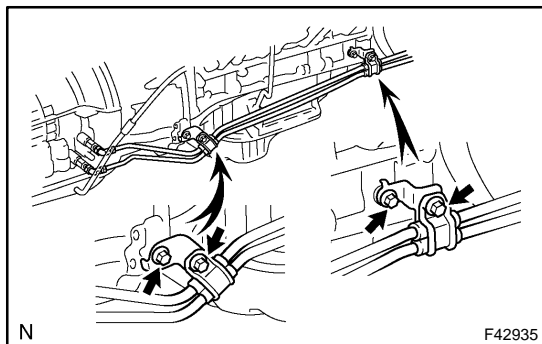

11. DISCONNECT OIL COOLER OUTLET TUBE NO.1
 - (a) Remove the 2 bolts and 2 clamps.

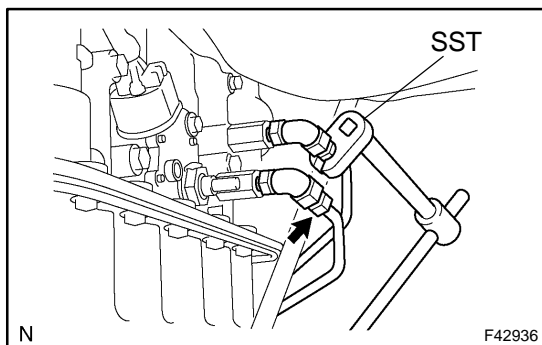

- (b) Using SST, disconnect the oil cooler outlet tube No.1.
SST 09023-12700

12. REMOVE OIL COOLER INLET TUBE NO.1

- (a) Using SST, disconnect the oil cooler inlet tube No.1.
SST 09023-12700

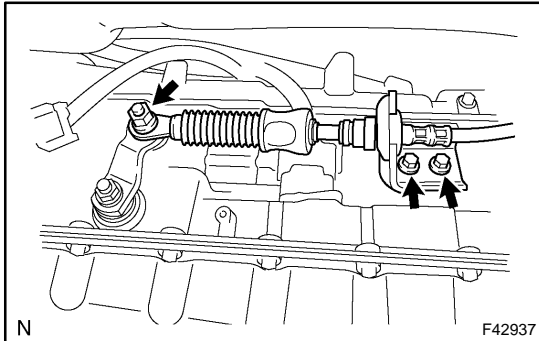
**13. DISCONNECT TRANSMISSION CONTROL CABLE ASSY**

- (a) Remove the nut and disconnect the transmission control cable.
(b) Remove the lock plate and disconnect the transmission control cable.

14. REMOVE TRANSMISSION CONTROL CABLE BRACKET NO.1

- (a) Remove the 2 bolts and transmission control cable bracket.

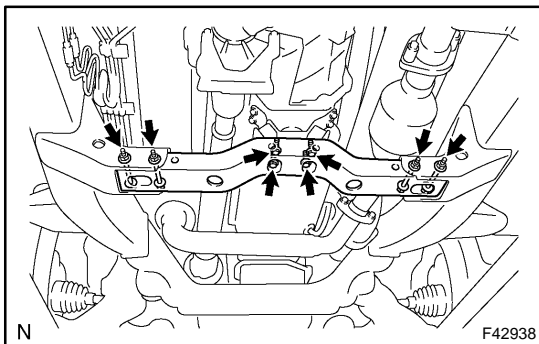
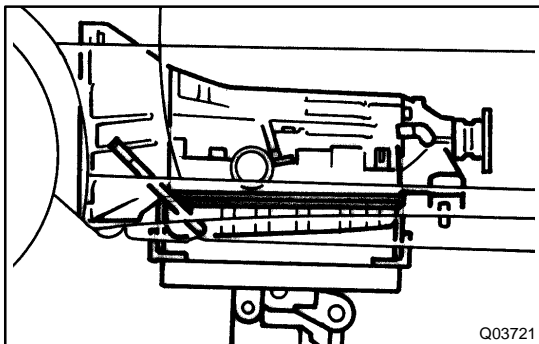
15. SUPPORT AUTOMATIC TRANSMISSION ASSY**16. REMOVE FRAME CROSSMEMBER SUB-ASSY NO.3**

- (a) Remove the 4 bolts on the frame crossmember sub-assy No.3.
(b) Remove the 4 nuts, 4 bolts and frame crossmember sub-assy No.3.

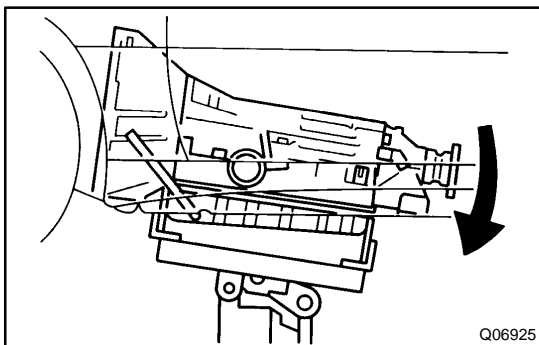
**17. DISCONNECT CONNECTOR**

- (a) Tilt down the transmission.

NOTICE:

Take care so that the cooling fan does not come in contact with the fan shroud.

- (b) Disconnect the park/neutral position switch connector.
(c) Disconnect the transmission wire connector.
(d) Disconnect the 2 speed sensor connectors.

18. DISCONNECT WIRE HARNESS

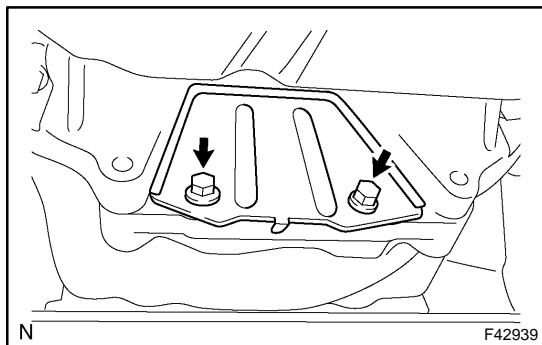
**19. REMOVE FLYWHEEL HOUSING UNDER COVER**

- (a) Remove the 2 bolts and flywheel housing under cover.

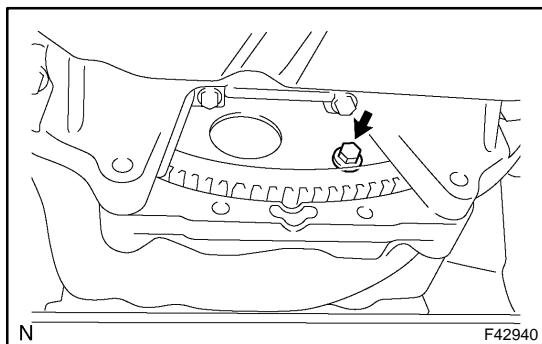
**20. REMOVE AUTOMATIC TRANSMISSION ASSY**

- (a) Turn the crankshaft to gain access to each bolt.
 (b) Hold the crankshaft pulley nut with a wrench and remove the 6 bolts.

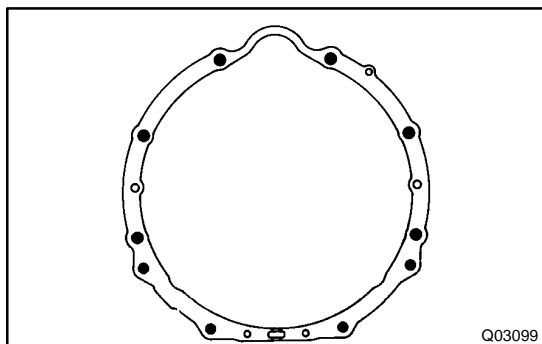

- (c) Remove the 10 bolts.
 (d) Separate and remove the automatic transmission.

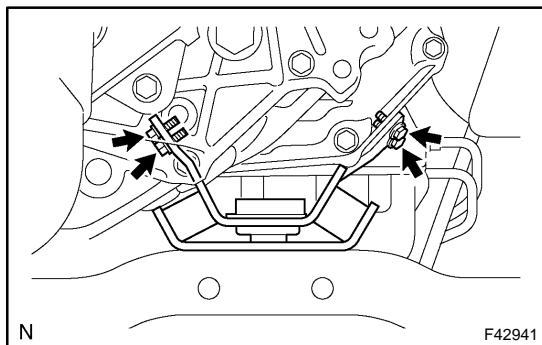
21. REMOVE TRANSFER ASSY (See page 31-12)**22. REMOVE ENGINE MOUNTING INSULATOR REAR NO.1**

- (a) Remove the 4 bolts and engine mounting insulator rear No.1.

23. REMOVE TORQUE CONVERTER CLUTCH ASSY**24. INSPECT TORQUE CONVERTER CLUTCH ASSY**

SST 09350-32014 (09351-32020)

25. INSTALL TORQUE CONVERTER CLUTCH ASSY

- (a) Install the torque converter clutch to the automatic transmission.

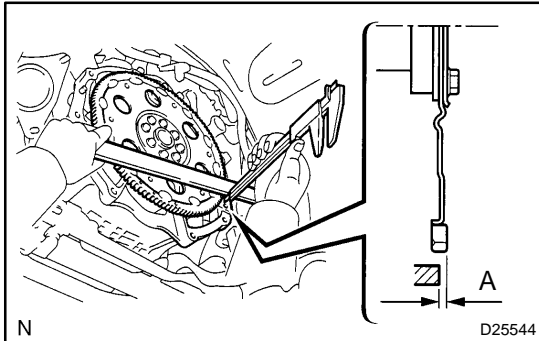

- (b) Using calipers and a straight edge, measure dimension A between the transmission and the end surface of the drive plate.

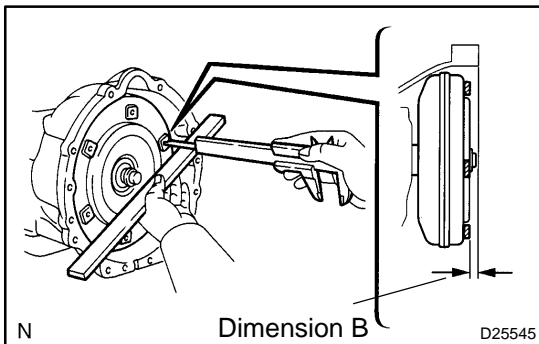

- (c) Using calipers and a straight edge, measure the dimension B shown in the illustration and check that B is greater than A measured in (b).

Standard: A + 1 mm or more

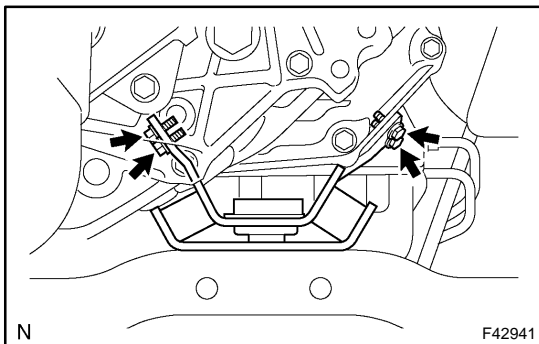
**26. INSTALL ENGINE MOUNTING INSULATOR REAR NO.1**

- (a) Install the engine mounting insulator rear and 4 bolts to the automatic transmission.

Torque: 65 N·m (663 kgf·cm, 48 ft·lbf)

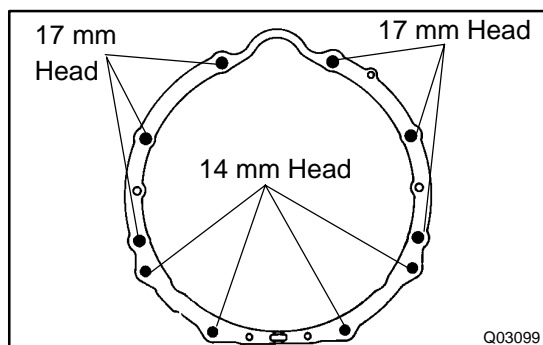
27. INSTALL TRANSFER ASSY (See page 31-12)**28. INSTALL AUTOMATIC TRANSMISSION ASSY**

- (a) Install the automatic transmission and 10 bolts to the engine.

Torque:

17 mm head: 71 N·m (720 kgf·cm, 53 ft·lbf)

14 mm head: 37 N·m (380 kgf·cm, 27 ft·lbf)

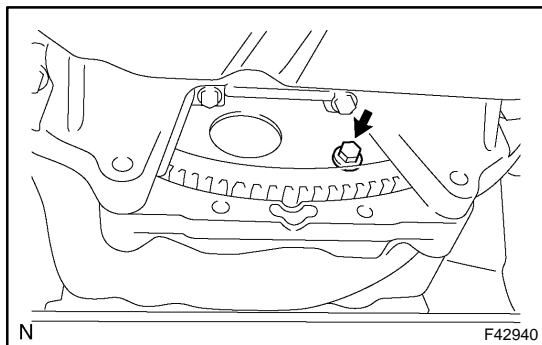

- (b) Install the 6 torque converter clutch mounting bolts.
Torque: 48 N·m (490 kgf·cm, 35 ft·lbf)

HINT:

First install black colored bolt and then the 5 bolts.

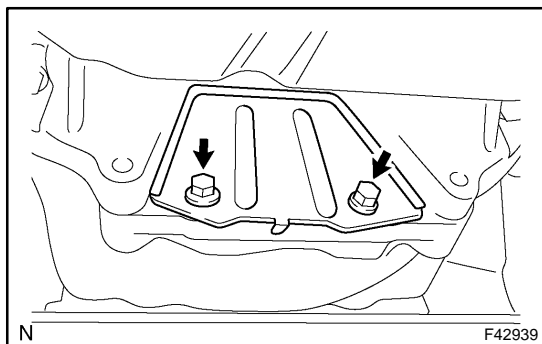

29. INSTALL FLYWHEEL HOUSING UNDER COVER

- (a) Install the flywheel housing under cover and 2 bolts.
Torque: 18 N·m (184 kgf·cm, 13 ft·lbf)

30. INSTALL WIRE HARNESS

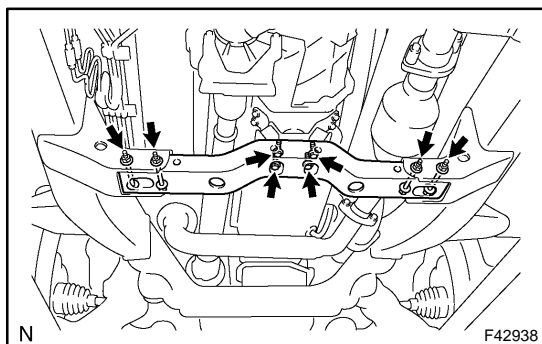

31. INSTALL FRAME CROSSMEMBER SUB-ASSY NO.3

- (a) Install the frame crossmember sub-assy No.3 with 4 bolts and 4 nuts.
Torque: 72 N·m (730 kgf·cm, 53 ft·lbf)
 (b) Install the frame crossmember sub-assy No.3 with 4 bolts.
Torque: 18 N·m (184 kgf·cm, 13 ft·lbf)

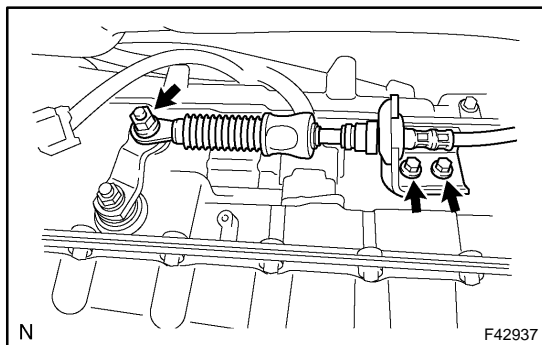

32. INSTALL TRANSMISSION CONTROL CABLE BRACKET NO.1

- (a) Install the transmission control cable bracket No.1 with 2 bolts.
Torque: 12 N·m (122 kgf·cm, 9 ft·lbf)

33. CONNECT TRANSMISSION CONTROL CABLE ASSY

- (a) Connect the transmission control cable with lock plate.
 (b) Connect the transmission control cable with nut.
Torque: 12 N·m (122 kgf·cm, 9 ft·lbf)

34. INSTALL OIL COOLER OUTLET TUBE NO.1

- (a) Temporarily install the oil cooler outlet tube No.1.
 (b) Temporarily install the oil cooler inlet tube No.1.

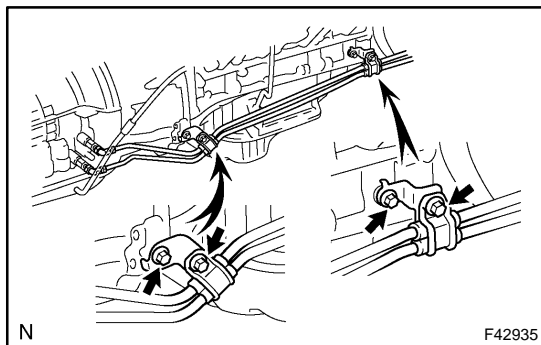

- (c) Install the 2 clamps and 2 bolts.
Torque: 5 N·m (50 kgf·cm, 43 in·lbf)

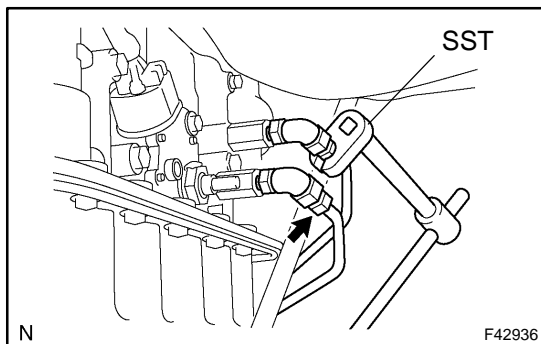

- (d) Using SST, tighten the oil cooler outlet tube No.1.
SST 09023-12700
Torque: 34 N·m (346 kgf·cm, 25 ft·lbf)

35. INSTALL OIL COOLER INLET TUBE NO.1

- (a) Using SST, tighten the oil cooler inlet tube No.1.
SST 09023-12700
Torque: 34 N·m (346 kgf·cm, 25 ft·lbf)

36. INSTALL TRANSMISSION OIL FILLER TUBE SUB-ASSY

- (a) Coat a new O-ring with ATF, and install them to the oil filler tube.
(b) Install the oil filler tube and bolt to the automatic transmission.
Torque: 12 N·m (122 kgf·cm, 9 ft·lbf)
(c) Install the ATF level gauge.

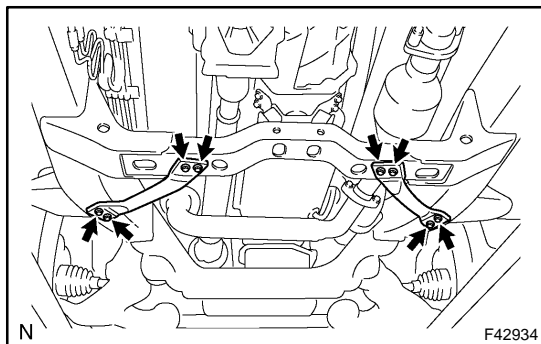

37. INSTALL FRONT SUSPENSION MEMBER BRACKET LH

- (a) Install the front suspension member bracket LH with 4 bolts.
Torque: 33 N·m (336 kgf·cm, 24 ft·lbf)

38. INSTALL FRONT SUSPENSION MEMBER BRACKET

- (a) Install the front suspension member bracket with 4 bolts.
Torque: 33 N·m (336 kgf·cm, 24 ft·lbf)

39. INSTALL PROPELLER SHAFT ASSY(See page 30-1 1)

40. INSTALL PROPELLER SHAFT ASSY FRONT(See page 30-4)

41. ADJUST SHIFT LEVER POSITION(See page 40-39)

42. INSTALL EXHAUST PIPE(See page 15-2)

43. INSTALL OXYGEN SENSOR(See page 15-2)

44. INSTALL ENGINE UNDER COVER SUB-ASSY NO.1

45. INSTALL ENGINE UNDER COVER ASSY REAR

46. ADD AUTOMATIC TRANSMISSION FLUID

47. INSPECT AUTOMATIC TRANSMISSION FLUID

48. INSPECT SHIFT LEVER POSITION

49. CHECK EXHAUST GAS LEAK